

STANDARD NOTES

- ALL WORKS IN THIS CONTRACT ARE TO BE CONSTRUCTED IN ACCORDANCE WITH THE CURRENT STANDARD DRAWINGS AND SPECIFICATIONS OF THE RELEVANT RESPONSIBLE AUTHORITIES. ANY DISPUTE THAT ARISES AT ANY TIME UNTIL THE RESPONSIBLE AUTHORITIES ACCEPT THE WORKS FOR FUTURE CARE AND MAINTENANCE, THE STANDARD DRAWING AND SPECIFICATION WILL TAKE PRECEDENCE OVER THE CONSTRUCTION PLAN.
- ALL ROADWORKS SIGNAGE IS TO BE IN ACCORDANCE WITH VICROADS WORKSITE TRAFFIC MANAGEMENT CODE OF PRACTICE INCORPORATING AS 1742.3.

SITE MANAGEMENT

- ALL WORKS ARE TO BE UNDERTAKEN IN ACCORDANCE WITH THE APPROVED CONSTRUCTION MANAGEMENT PLAN.
- ALL TREES, SHRUBS ETC ARE TO BE RETAINED UNLESS OTHERWISE INDICATED.
- DURING THE CONSTRUCTION AND MAINTENANCE PERIOD SILT FENCES ARE TO BE PLACED DOWNSTREAM OF ALL EXPOSED AREAS, AND SILT BARRIERS ARE TO BE PLACED UPSTREAM OF ALL PITS. THE SILT FENCES AND SILT BARRIERS ARE TO BE CHECKED AND MAINTAINED UNTIL THE END OF THE MAINTENANCE PERIOD.
- ALL AREAS OF THE SUBDIVISION EXPOSED OF VEGETATION, INCLUDING NATURESTRIPS, LOTS AND RESERVE ARE TO BE FULLY GRASSED BY HYDROMULCHING, WATERING AND MAINTAINED UNTIL THE END OF THE MAINTENANCE PERIOD.

GENERAL

- THE CONTRACTOR SHALL:
 - GIVE 5 DAYS NOTICE IN WRITING TO COGG SUBDIVISIONS ENGINEER OR REPRESENTATIVE PRIOR TO THE COMMENCEMENT OF WORKS.
 - NOTIFY COGG SUBDIVISIONS ENGINEER OR REPRESENTATIVE 24 HOURS PRIOR TO WORKING ON ANY WEEKEND.
 - BE FULLY AWARE OF ALL SITE CONDITIONS PRIOR TO TENDERING.
 - BE RESPONSIBLE FOR LOCATING ALL EXISTING SERVICES PRIOR TO THE COMMENCEMENT OF WORKS AND SHALL BE RESPONSIBLE FOR ANY DAMAGE TO THE SERVICES.
 - BE RESPONSIBLE FOR THE INSTALLATION OF ALL SERVICES REQUIRED FOR THE PROJECT.
 - ENSURE THAT ALL SERVICES ARE INSTALLED TO THE SPECIFIED OFFSETS AND MEETS MINIMUM COVER REQUIREMENTS. ALL SURFACE FIXTURES, PITS, VALVES, FIREPLUGS, ETC. SHALL BE INSTALLED A MINIMUM OF 6.0m FROM ANY SIDE BOUNDARY IN THE ROAD RESERVE AND SHALL MATCH THE REQUIRED FINISHED SURFACE LEVEL. THIS APPLIES TO ALL SERVICES REQUIRED FOR THE PROJECT IRRESPECTIVE IF THEY ARE INSTALLED BY THE CONTRACTOR OR OTHERWISE.
 - COMPLY WITH THE REQUIREMENTS OF THE MINES ACT 1958 AND RELEVANT REGULATIONS INCLUDING NOTIFICATION IN WRITING (CLAUSE 395) TO THE CHIEF MINING INSPECTOR OF THE INTENTION TO COMMENCE EXCAVATION OPERATIONS WHERE ANY TRENCH IS 1.5m OR MORE IN DEPTH.
 - GIVE 24 HOURS NOTICE TO COGG SUBDIVISIONS ENGINEER OR REPRESENTATIVE PRIOR TO BACKFILLING OF ANY PIPE TRENCHES OR LAYING OF ANY PAVEMENT OR CONCRETE WORKS SO THAT THE WORKS CAN BE CHECKED AND APPROVED.
 - COMPLY WITH THE OCCUPATIONAL HEALTH AND SAFETY (CONFINED SPACES) REGULATIONS AND CODE OF PRACTICE FOR CONFINED SPACES.
 - BE RESPONSIBLE FOR THE COMPACTION AND/OR ANY OTHER REQUIRED TESTING OF THE PAVEMENT MATERIAL BY AN APPROVED GEOTECHNICAL CONSULTANT AS AND WHEN DIRECTED BY COGG SUBDIVISIONS ENGINEER OR REPRESENTATIVE.
- ANY WORKS WITHIN ROADWAYS SHALL SATISFY COUNCIL'S "REQUIREMENTS FOR OCCUPANCY OF ROAD RESERVE". CONTACT COGG TRAFFIC MANAGEMENT OFFICER ON TELEPHONE (03) 52724384. FOR FURTHER SPECIFIC DETAILS RELATING TO THIS PROJECT A COPY OF THE TRAFFIC MANAGEMENT PLAN IS TO BE FORWARDED TO THE COGG SUBDIVISIONS ENGINEER OR REPRESENTATIVE PRIOR TO WORKS COMMENCING.
- ALL REASONABLE CARE SHALL BE TAKEN BY THE CONTRACTOR TO PRESERVE THE SURVEY PEGS. ANY REINSTATEMENT OF BOUNDARY PEGS FOR CONSTRUCTION IS THE RESPONSIBILITY OF THE CONTRACTOR. BENCHMARK VALUES ARE VALID FOR 6 MONTHS FROM THE ISSUED DATE OF THE SURVEY AND ARE TO BE CHECKED PRIOR TO COMMENCEMENT OF WORKS AND ANY DISCREPANCIES ARE TO BE REPORTED IMMEDIATELY.
- ALL DIMENSIONS ARE IN METRES AND LEVELS ARE TO AUSTRALIAN HEIGHT DATUM (A.H.D.)
- ALL SEWER MANHOLES LOCATED UNDER NEW FOOTPATH TO HAVE OFFSET COVER ROTATED AND LEVELS ADJUSTED SO THAT THE COVERS ARE ENTIRELY LOCATED WITHIN THE FOOTPATH WITH APPROPRIATELY POSITIONED JOINTS IN PATH AND FLUSH WITH SURFACE.

ROADWORKS

- SUBSOIL DRAINS ARE TO BE CONSTRUCTED BEHIND THE KERB AND CHANNEL OR AS DIRECTED BY THE COGG SUBDIVISIONS ENGINEER OR REPRESENTATIVE.
- WHERE DRAINAGE LINES EXIST BEHIND THE KERB AND CHANNEL SUBSOIL DRAINAGE IS NOT REQUIRED HOWEVER A 1m LENGTH OF SUBSOIL DRAIN INCLUDING FILTER SOCK IS REQUIRED BOTH SIDES OF DRAINAGE PITS.
- ALL FOOTPATHS ARE TO BE A MINIMUM OF 125mm THICK WITH SL72 REINFORCEMENT AND BEDDED ON A MINIMUM OF 50MM COMPACTED CLASS 3 FCR WITH THE BEDDING TO EXTEND 100mm BEYOND THE EDGES OF THE PROPOSED FOOTPATH PRIOR TO THE PLACEMENT OF THE TIMBERS AND BOARDS. CONTRACTION OR EXPANSION JOINTS ARE TO BE CONSTRUCTED BETWEEN 10 TO 15 METER INTERVALS
- WHERE FILLING IS REQUIRED UNDER THE FOOTPATH BEDDING MATERIAL THEN CLASS 4 FCR IS TO BE USED UNLESS OTHERWISE APPROVED BY THE COGG SUBDIVISIONS ENGINEER.
- CONCRETE FOR KERB AND CHANNEL USED IN EXTRUSION MACHINES SHALL HAVE A MINIMUM CEMENT CONTENT OF 320 KG/M3.
- CONCRETE FOR STORMWATER PITS AND ANY OTHER STORMWATER RELATED STRUCTURE IS TO HAVE A MINIMUM STRENGTH OF 32 MPA AT 28 DAYS.
- CONCRETE FOR ALL OTHER APPLICATIONS IS TO HAVE A MINIMUM STRENGTH OF 25 MPA AT 28 DAYS.
- TO ALLOW FOR A CONTINUOUS CONCRETE KERB AND CHANNEL POUR THE STORMWATER PIT CONCRETE SURROUND IS TO BE IN PLACE PRIOR TO THE POUR COMMENCING. IF THE PIT SURROUNDS ARE NOT IN PLACE THEN THE INITIAL KERB AND CHANNEL POUR IS TO STOP ONE METRE EITHER SIDE OF EVERY PIT.
- PRIOR TO ANY FILLING ON LOTS ALL TOPSOIL IS TO BE REMOVED AND STOCKPILED. THE FILL MUST BE APPROVED AND CONSISTED IN 150mm COMPACTED LAYERS TO A DRY DENSITY OF 95% STANDARD COMPACTION IN ACCORDANCE WITH AS1289. THE TOPSOIL IS THEN TO BE UNIFORMLY REPLACED TO A COMPACTED DEPTH OF 100mm. COMPACTION TESTING WILL BE REQUIRED AT THE DISCRETION OF THE COGG SUBDIVISIONS ENGINEER OR REPRESENTATIVE.
- ALLOTMENTS SHALL BE GRADED TO AN EVEN SURFACE AT THE COMPLETION OF ALL WORKS AND SHALL HAVE A MINIMUM GRADE OF 1 IN 200 (IDM) TO THEIR NOMINATED DRAINAGE CONNECTION POINTS. ALL SURPLUS SPOIL, BOXTHORN, FENCING, CONSTRUCTION WASTE AND OTHER RUBBISH SHALL BE REMOVED FROM SITE AT THE COMPLETION OF WORKS.
- BATTER SLOPES ON LOTS SHALL BE A MAXIMUM OF 1 IN 6 FOR FILL AND 1 IN 3 FOR CUT UNLESS OTHERWISE SHOWN.
- ROUNDED-TOPPED WHITE CYPRUS HARVESTED FROM SUSTAINABLE FOREST BOLLARDS (0.6m HIGH) OR AS APPROVED BY COUNCIL PARKS/RECREATION AND OPEN SPACE/ENVIRONMENT DEPARTMENTS ARE TO BE PLACED ACROSS THE RESERVE FRONTAGE AT 1.5M CENTRES, REFER TO COUNCIL STANDARD DRAWING COGG 701. A DEMOUNTABLE SECTION FOR VEHICLE ACCESS TO COUNCIL STANDARDS, REFER STANDARD DRAWING COGG702 & COGG703.
- STREET SIGNS ARE TO BE LOCATED AS INDICATED ON THE PLANS AND INSTALLED IN ACCORDANCE WITH VICROADS TRAFFIC ENGINEERING MANUAL VOLUME 2. MOUNTING HEIGHT IS TO BE TO THE UNDERSIDE OF THE SIGN AND IS TO BE A MINIMUM OF 2.1m AND MAXIMUM OF 3.0m.
- 'NO THROUGH ROAD' SIGN IS TO BE INSTALLED BELOW THE STREET SIGN WHERE APPLICABLE.
- ALL REINFORCEMENT USED IN CONCRETE WORKS FOR FOOTPATH DRIVEWAYS AND ROADS IS TO BE ADEQUATELY SUPPORTED BY APPROPRIATE SIZED BAR CHAIRS PRIOR TO THE POURING/PLACEMENT OF CONCRETE.
- AT THE TERMINATION OF STAGED PAVEMENT CONSTRUCTION, A CONCRETE EDGE STRIP 200mm X 200mm AND SUBSOIL DRAIN IS TO BE INSTALLED ACROSS THE WIDTH OF THE PAVEMENT AND A 'NO THROUGH ROAD' AND CHEVRON MARKER SIGNS ARE TO BE INSTALLED ACROSS THE FULL WIDTH OF THE ROAD RESERVE. APPROPRIATE RETAINING WALLS/FENCING IS TO BE PROVIDED AS DIRECTED BY COGG SUBDIVISIONS ENGINEER OR REPRESENTATIVE.
- WHERE LINE MARKING NEEDS TO BE REMOVED, THESE LINES ARE TO BE PERMANENTLY REMOVED EITHER BY GRINDING THE OLD LINES OFF OR BY PLACING A SEAL AND GRIT TREATMENT (USING THE 'FLOCON' SYSTEM) OVER THE UNWANTED LINES.
- LOT NUMBERS SHALL BE STENCILED IN 50mm HIGH FIGURES WITH WHITE PAINT ON THE FACE OF THE KERB AND CHANNEL.
- CIVIL CONTRACTOR TO CONTACT SUPERINTENDENT MINIMUM OF 7 DAYS PRIOR TO POURING ANY KERB & CHANNEL TO ENSURE THAT DRIVEWAY LOCATIONS HAVE NOT ALTERED.

DRAINAGE

- PIPE DRAINAGE WITHIN ROADWAYS TO BE REINFORCED CONCRETE PIPES - CLASS 2 UNLESS OTHERWISE SHOWN.
- ALL REINFORCED CONCRETE PIPES ARE TO BE RUBBER RING JOINTED.
- PIPES IN EASEMENTS ARE TO BE RUBBER RING JOINTED OR UPVC SEWER CLASS PIPES WITH SOLVENT CEMENT JOINTS.
- ALL DRAINAGE PITS IN COUNCIL ROAD RESERVES, DRAINAGE RESERVES AND RECREATION RESERVES ARE TO HAVE LIDS THAT ARE AT LEAST CLASS D (HEAVY DUTY) IN ACCORDANCE WITH AUSTRALIAN STANDARD AS 3996.
- ALL PITS ARE TO BE SET OUT FROM SURVEY CO-ORDINATES USING SET OUT POINTS DETAILED IN THE COGG STANDARD DRAWINGS.
- ALL PIPES UNDER FOOTPATHS, DRIVEWAYS AND BEHIND BACK OF KERB SHALL BE BACKFILLED WITH 20mm NOM SIZE CLASS 3 FINE CRUSHED ROCK (WETMIX) COMPACTED TO 95% MODIFIED COMPACTION IN 150mm MAXIMUM LAYERS.
- CONTRACTOR TO USE 2% CEMENT STABILISED SAND FROM THE BOTTOM OF THE STORMWATER PIPE TO THE SPRINGLINE WHEN DRAINAGE IS CONSTRUCTED UNDER THE ROAD. CLASS 3 CRUSHED ROCK TO BE USED FOR BACKFILL FROM THE SPRINGLINE TO THE PAVEMENT SUB-BASE.
- PIPEWORK AT ALL PITS TO BE WELL ALIGNED TO ENSURE FLOW IS GUIDED DIRECTLY TO OUTLET PIPE.
- ALL PIPELINES ARE TO BE INSPECTED VIA CCTV AT PRACTICAL COMPLETION AT THE CONTRACTORS' EXPENSE AND UNDER THE SUPERVISION OF COGG SUBDIVISIONS ENGINEER OR REPRESENTATIVE.
- PROPERTY INLET PITS TO BE LOCATED 1M FROM THE LOW CORNER UNLESS OTHERWISE SHOWN.
- HOUSE DRAINS ARE TO BE 100mm DIAMETER SEWER CLASS PVC SOCKETED PIPES LOCATED 6.5m FROM THE LOW CORNER OF THE LOT UNLESS OTHERWISE SHOWN. OPTION "No. 1" IS TO CONNECT TO A PIT, "No.2" IS TO CONNECT TO THE UNDERGROUND DRAINAGE PIPE AND "No.3" IS TO KERB (MINIMUM 1.0m AWAY FROM EDGE OF VEHICLE LAYBACK).
- HOUSE DRAINS ARE TO BE A MINIMUM OF 0.5m BELOW FINISHED SURFACE AT THE LOT BOUNDARY UNLESS OTHERWISE SHOWN.
- EASEMENT DRAIN CONNECTION TO BE A MINIMUM OF 0.5m BELOW FINISHED SURFACE UNLESS OTHERWISE SHOWN.
- WHEN USING 150mm DIAMETER UPVC SEWER CLASS PIPES IN EASEMENTS FOR PRIVATELY OWNED PROPERTIES, THE HOUSE DRAINS ARE TO BE CONNECTED USING STANDARD T-PIECE FITTINGS.
- WHEN USING 225mm DIAMETER OR LARGER UPVC PIPES, HOUSE DRAINS ARE TO BE CONNECTED IN A SIMILAR WAY TO CONCRETE PIPES SUBJECT TO THE INLET BEING CORE DRILLED.
- WATER AND GAS SERVICE CONDUITS SHALL BE LOCATED CLEAR OF ALL DRIVEWAY CROSSINGS AND SHALL EXTEND FROM THE POINT OF SUPPLY TO AT LEAST 500mm INSIDE THE HOUSE LOT TO BE SERVICED AND LEFT EXPOSED UNTIL INSPECTED BY COGG SUBDIVISIONS ENGINEER. WATER CONDUITS ARE TO BE LOCATED AT LEAST 6.5m FROM SIDE BOUNDARY. GAS CONDUITS ARE TO BE LOCATED 2m FROM "NON-DRIVEWAY" SIDE BOUNDARY OF LOT TO BE SERVICED. CONDUIT TRENCHES ARE TO BE BACKFILLED WITH CLASS 3 FCR. NEXT TO WATER CONDUIT IS PREFERRED.
- THE LOCATION OF HOUSE DRAINS (H) AND SERVICE CONDUITS (W, G, T, AND E) ARE TO BE NEATLY ETCHED ON THE KERB FACE WITH 50mm HIGH LETTERS.
- IN ROAD RESERVE EXISTING OPEN DRAINS ARE TO BE CLEANED OUT TO AN APPROVED BASE AND ANY SPOIL IS TO BE REMOVED FROM THE SITE. STRUCTURAL FILL (CLASS 4 MINIMUM) IS TO BE PLACED IN NOT MORE THAN 150mm LAYERS AND COMPACTED TO A MINIMUM OF 98% STANDARD COMPACTION. COMPACTION TESTS ARE TO BE PROVIDED TO THE SATISFACTION OF COGG SUBDIVISIONS ENGINEER OR REPRESENTATIVE.
- ALL SUMPS IN PRE-CAST CONCRETE PITS ARE TO BE INFILLED WITH CONCRETE FLUSH TO THE INVERT LEVEL OF THE OUTLET PIPE, UNLESS APPROVED OTHERWISE BY THE COUNCIL WORKS INSPECTOR.
- ALL DRAINAGE PIT LIDS ARE TO BE 'TERRA-FIRMA' OR APPROVED EQUIVALENT.



GEELONG LAND GROUP PTY LTD
HIGHTON RIDGE ESTATE

STAGE 10C
HIGHTON, VIC, 3216

INDEX

SHEET 1	REV A	INDEX AND NOTES
SHEET 2	REV A	ROAD LAYOUT PLAN
SHEET 3	REV A	MASTER SERVICE PLAN
SHEET 4	REV A	RESERVE DETAIL PLAN
SHEET 5	REV A	ROAD LONGITUDINAL SECTION - MAJESTIC DRIVE
SHEET 6	REV A	ROAD CROSS SECTIONS - MAJESTIC DRIVE
SHEET 7	REV A	ROAD CROSS SECTIONS - MAJESTIC DRIVE
SHEET 8	REV A	ROAD CROSS SECTIONS - MAJESTIC DRIVE
SHEET 9	REV A	ROAD CROSS SECTIONS - MAJESTIC DRIVE
SHEET 10	REV A	ROAD CROSS SECTIONS - MAJESTIC DRIVE
SHEET 11	REV A	ROAD CROSS SECTIONS - MAJESTIC DRIVE
SHEET 12	REV A	DRAINAGE LONGITUDINAL SECTIONS AND PIT SCHEDULE



LOCALITY PLAN

MELWAYS REF: 450 H6

FOR CONSTRUCTION

ISSUE	ISSUED FOR	DATE	No.	AMENDMENT	DATE	DRAWN	APPROVED	DESIGNED	DRAWN	CHECKED	POS NO.	VERSION	PERMIT NO.	CLIENT:	PROJECT:	STAGE	CIVIL DRAWING
00	FOR APPROVAL	27/04/18						D. RICHARDSON	H. SMITH					GEELONG LAND GROUP PTY LTD		STAGE 10C	
01	FOR CONSTRUCTION	10/09/19												P.O BOX 315		HIGHTON	
A	FOR CONSTRUCTION	10/02/2020												GEELONG, VIC, 3220		VIC, 3216	
WORKS SHALL NOT COMMENCE UNTIL PLANS ARE SIGNED AND APPROVED FOR CONSTRUCTION														THIS ELECTRONIC DRAWING IS PRODUCED BY AUTOCAD (R) SYSTEMS AND REMAINS THE PROPERTY OF CardnoTGM GROUP Pty Ltd. IT MAY NOT BE REPRODUCED IN ANY FORMAT WITHOUT WRITTEN PERMISSION			
JAS-ANZ Accredited: Quality ISO 9001 - CHMS AS/NZS 4801 - Environment ISO 14001														CITY OF GREATER GEELONG			
CardnoTGM REF. No. 007138-210C														SHEET: 1 OF 12 REV: A			

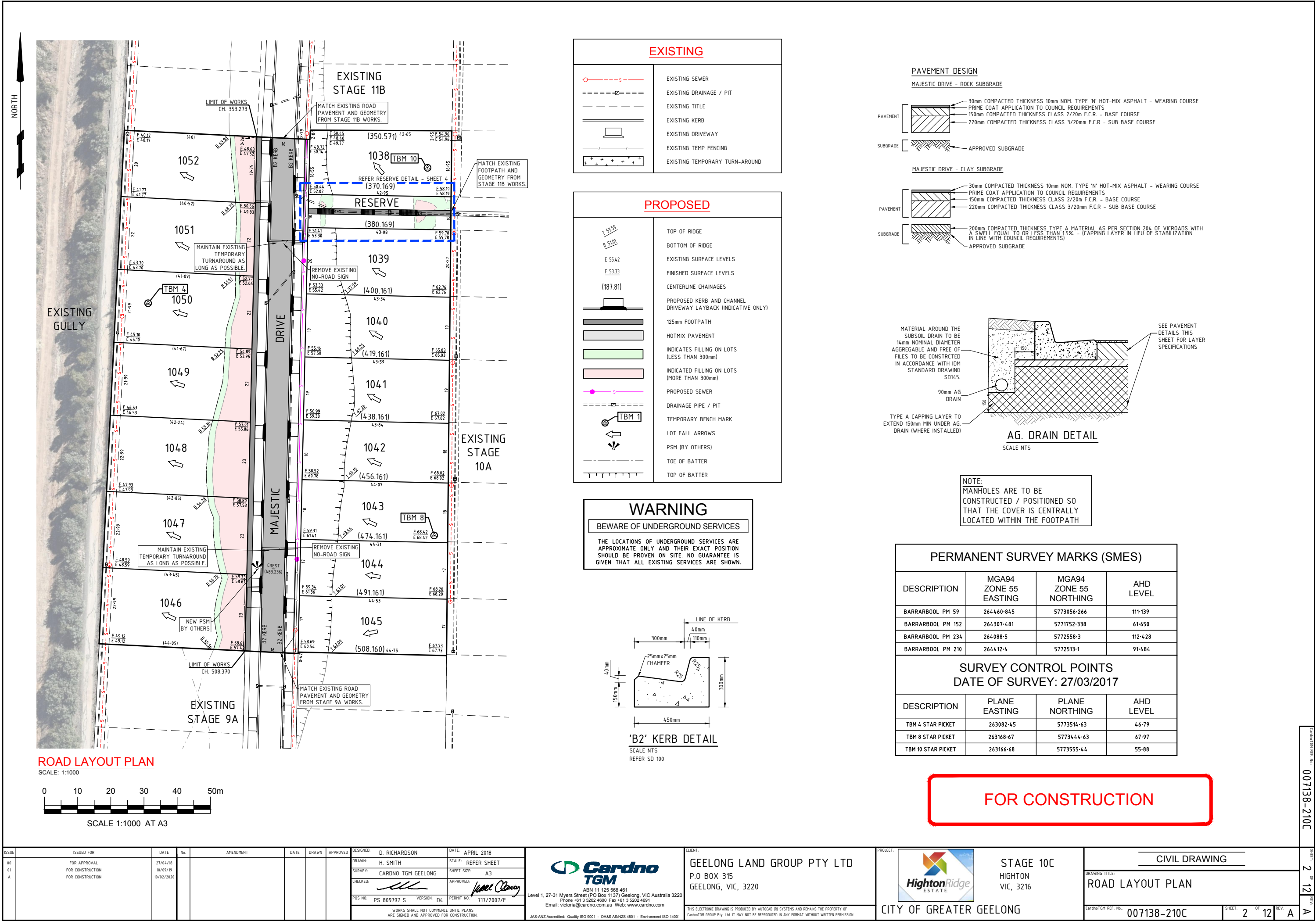

FOR CONSTRUCTION

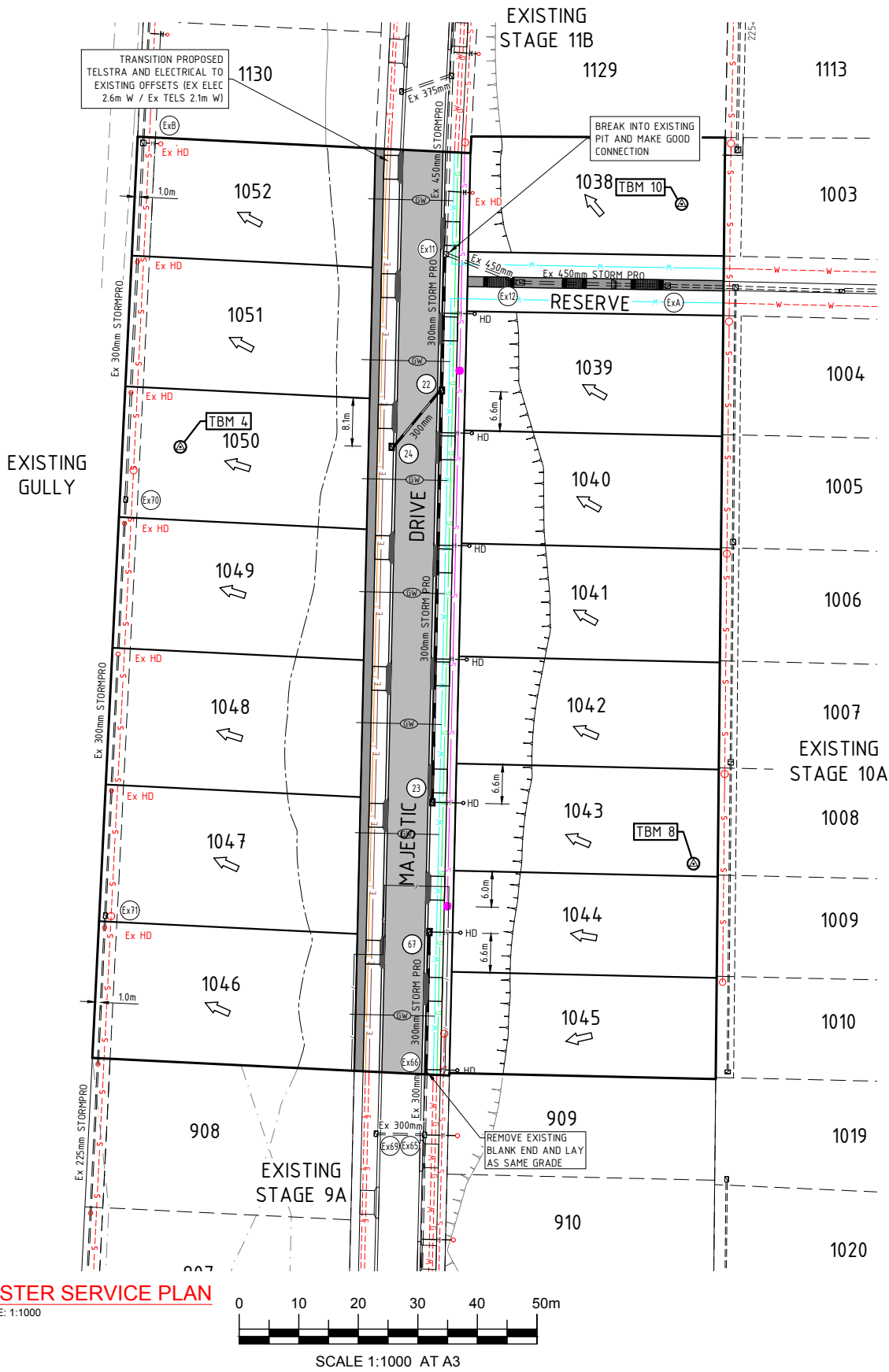

PROPOSED	
	PROPOSED KERB AND CHANNEL
	DRIVEWAY LAYBACK (INDICATIVE ONLY)
	125mm FOOTPATH
	HOTMIX PAVEMENT
	PROPOSED ELECTRICAL
	PROPOSED GAS
	PROPOSED TELSTRA
	PROPOSED SEWER
	PROPOSED WATER
	PROPOSED PIPE DRAINAGE / PIT
	PROPOSED HOUSE DRAIN
	TEMPORARY BENCH MARK
	LOT FALL ARROWS
	PROPOSED GAS/WATER CONDUIT
	TOE OF BATTER
	TOP OF BATTER

EXISTING	
	EXISTING ELECTRICAL
	EXISTING GAS
	EXISTING TELSTRA
	EXISTING SEWER
	EXISTING WATER
	EXISTING DRAINAGE / PIT
	EXISTING TITLE
	EXISTING KERB
	EXISTING DRIVEWAY
	EXISTING HOUSE DRAIN

SERVICE LOCATIONS					
	WATER	GAS	SEWER	TELEPHONE	ELEC.
MAJESTIC DRIVE	2.7 E	2.1 E	1.0 E	1.9 W	2.5 W
RESERVE	2.7 E	2.1 E	1.0 E	1.9 W	2.5 W

NOTE:
1. EXISTING DRAINAGE HOUSE CONNECTIONS PROVIDED FOR LOTS 1038 & 1046-1052.

WARNING
BEWARE OF UNDERGROUND SERVICES
THE LOCATIONS OF UNDERGROUND SERVICES ARE APPROXIMATE ONLY AND THEIR EXACT POSITION SHOULD BE PROVEN ON SITE. NO GUARANTEE IS GIVEN THAT ALL EXISTING SERVICES ARE SHOWN.

NOTE:
MANHOLES ARE TO BE CONSTRUCTED / POSITIONED SO THAT THE COVER IS CENTRALLY LOCATED WITHIN THE FOOTPATH

PERMANENT SURVEY MARKS (SMES)			
DESCRIPTION	MGA94 ZONE 55 EASTING	MGA94 ZONE 55 NORTHING	AHD LEVEL
BARRARBOOL PM 59	264460-845	5773056-266	111-139
BARRARBOOL PM 152	264307-481	5771752-338	61-650
BARRARBOOL PM 234	264088-5	5772558-3	112-428
BARRARBOOL PM 210	264412-4	5772513-1	91-484
SURVEY CONTROL POINTS			
DATE OF SURVEY: 27/03/2017			
DESCRIPTION	PLANE EASTING	PLANE NORTHING	AHD LEVEL
TBM 4 STAR PICKET	263082-45	5773514-63	46-79
TBM 8 STAR PICKET	263168-67	5773444-63	67-97
TBM 10 STAR PICKET	263166-68	5773555-44	55-88

ISSUE	ISSUED FOR	DATE	No.	AMENDMENT	DATE	DRAWN	APPROVED	DESIGNED	DATE
00	FOR APPROVAL	27/04/18						D. RICHARDSON	APRIL 2018
01	FOR CONSTRUCTION	10/09/19						H. SMITH	SCALE: 1:1000
A	FOR CONSTRUCTION	10/02/2020						CARDNO TGM GEELONG	SHEET SIZE: A3
CHECKED:									APPROVED:
POS NO: PS 809797 S VERSION: D4 PERMIT NO: 717/2007/F									
WORKS SHALL NOT COMMENCE UNTIL PLANS ARE SIGNED AND APPROVED FOR CONSTRUCTION									
JAS-ANZ Accredited: Quality ISO 9001 - CHMS AS/NZS 4801 - Environment ISO 14001									
CLIENT: GEELONG LAND GROUP PTY LTD P.O BOX 315 GEELONG, VIC, 3220									
PROJECT:									
CITY OF GREATER GEELONG									
STAGE 10C HIGHTON VIC, 3216									
CIVIL DRAWING									
DRAWING TITLE: MASTER SERVICE PLAN									
CardnoTGM REF. No. 007138-210C									
SHEET: 3 OF 12 REV: A									

ALWAYS CHECK THE SERVICES ON THE LOT! DO NOT RELY SOLELY ON THIS PLAN!

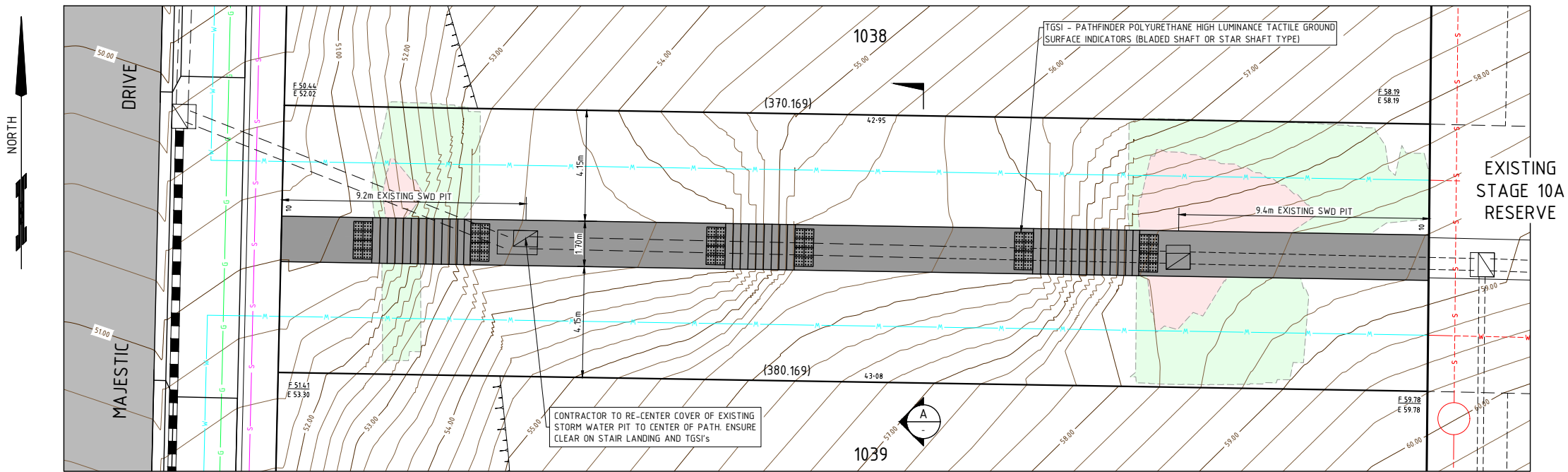

RESERVE DETAIL PLAN
SCALE: 1:200

NOTE:
REFER TGM STRUCTURAL DRAWINGS 007138-16
FOR ADDITIONAL INFO ON LEVELS, SERVICES
AND ALL OTHER ASSOCIATED WORKS.

PROPOSED

- PROPOSED KERB AND CHANNEL DRIVEWAY LAYBACK (INDICATIVE ONLY)
- INDICATES FILLING ON LOTS (LESS THAN 300mm)
- INDICATED FILLING ON LOTS (MORE THAN 300mm)
- 125mm FOOTPATH
- HOTMIX PAVEMENT
- PROPOSED GAS
- PROPOSED SEWER
- PROPOSED WATER
- PROPOSED PIPE DRAINAGE / PIT
- MAJOR CONTOUR (1M INTERVAL)
- MINOR CONTOUR
- EXISTING SURFACE LEVEL
- FINISHED SURFACE LEVEL
- TGSIs (INDICATIVE)

EXISTING

- EXISTING SEWER
- EXISTING WATER
- EXISTING DRAINAGE / PIT

WARNING
BEWARE OF UNDERGROUND SERVICES

THE LOCATIONS OF UNDERGROUND SERVICES ARE APPROXIMATE ONLY AND THEIR EXACT POSITION SHOULD BE PROVEN ON SITE. NO GUARANTEE IS GIVEN THAT ALL EXISTING SERVICES ARE SHOWN.

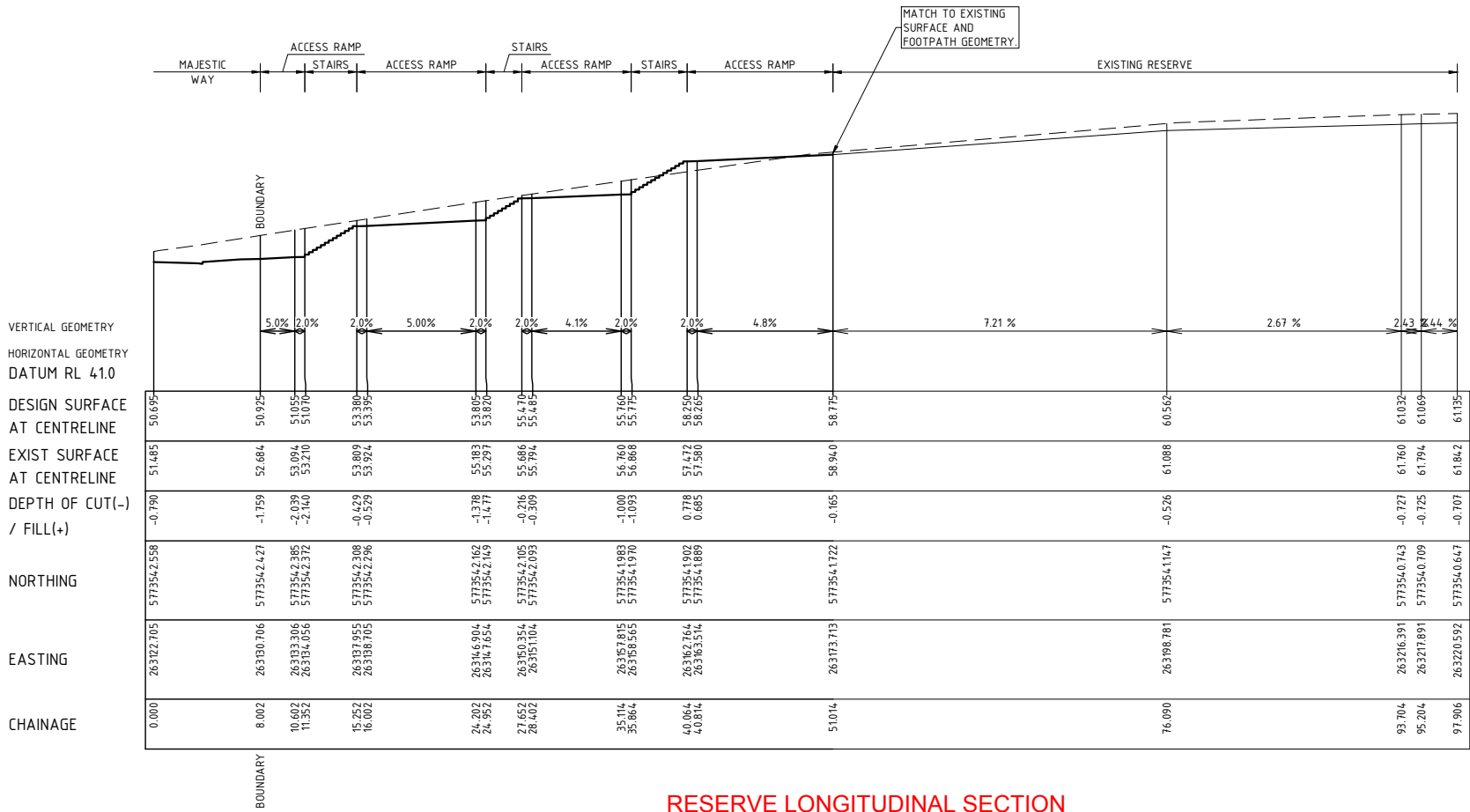

RESERVE LONGITUDINAL SECTION
HORZ: 1:500
VERT: 1:500

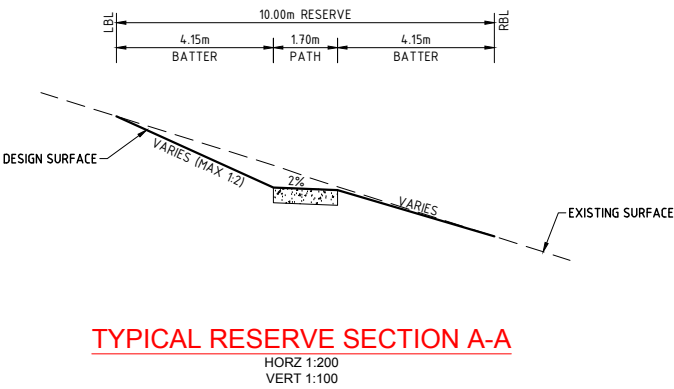

FOR CONSTRUCTION

ISSUE	ISSUED FOR	DATE	No.	AMENDMENT	DATE	DRAWN	APPROVED	DESIGNED	DATE	CLIENT	PROJECT	STAGE	DRAWING TITLE	CardnoTGM REF. No.	SHEET	OF	REV	A
00	FOR APPROVAL	27/04/18						D. RICHARDSON	APRIL 2018	GEELONG LAND GROUP PTY LTD	HightonRidge	STAGE 10C	CIVIL DRAWING	007138-210C	4	12	A	A
01	FOR CONSTRUCTION	10/09/19						H. SMITH	REFER SHEET	P.O BOX 315		HIGHTON	RESERVE DETAIL PLAN					
A	FOR CONSTRUCTION	10/02/2020						CARDNO TGM GEELONG	A3	GEELONG, VIC, 3220		VIC, 3216						
								CHECKED: [Signature]	APPROVED: [Signature]									
								POS NO: PS 809797 S	PERMIT NO: 717/2007/F									
								WORKS SHALL NOT COMMENCE UNTIL PLANS ARE SIGNED AND APPROVED FOR CONSTRUCTION										
								CardnoTGM										
								ABN 11 125 568 461										
								Level 1, 27-31 Myers Street (PO Box 1137) Geelong, VIC Australia 3220										
								Phone +61 3 5202 4000 Fax +61 3 5202 4891										
								Email: victoria@cardno.com.au Web: www.cardno.com										
								JAS-ANZ Accredited: Quality ISO 9001 - CHMS AS/NZS 4801 - Environment ISO 14001										
								THIS ELECTRONIC DRAWING IS PRODUCED BY AUTOCAD (R) SYSTEMS AND REMAINS THE PROPERTY OF CardnoTGM GROUP Pty Ltd. IT MAY NOT BE REPRODUCED IN ANY FORMAT WITHOUT WRITTEN PERMISSION										

DISCLAIMER: ACCURACY OF THESE PLANS IS NOT GUARANTEED. FOR INDICATIVE LOCATIONS ONLY. MAKE YOUR OWN ENQUIRIES.

FOR CONSTRUCTION

TP = TANGENT POINT
CREST = HIGH POINT
SAG = LOW POINT
IP = INTERSECTION POINT

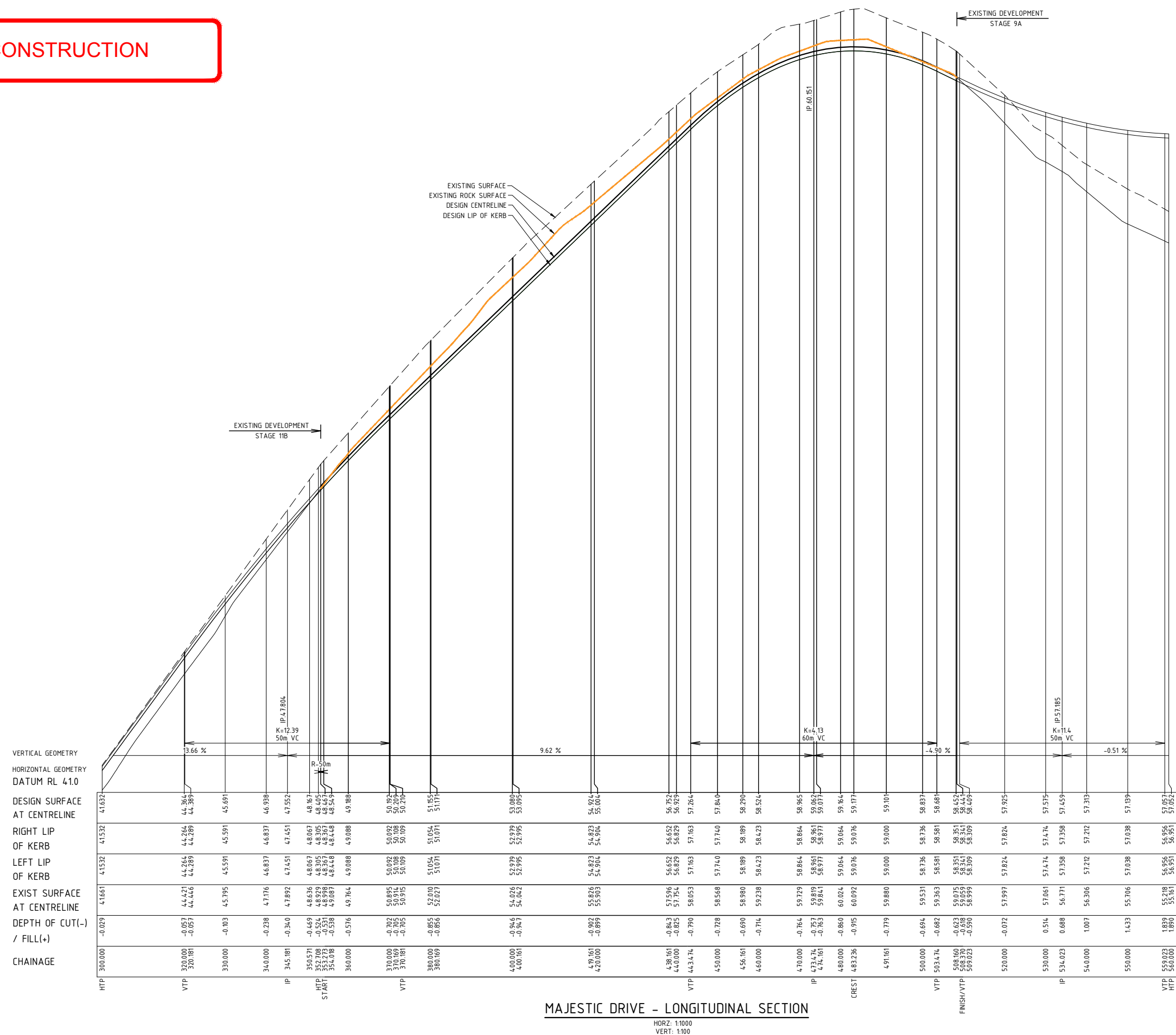

MAJESTIC DRIVE - LONGITUDINAL SECTION

HORZ: 1:1000
VERT: 1:100

[illegible]

J:\007138 (HIGHTON RIDGE)\210C-CE\DWG\007138-210C (CIVIL) REVA.DWG

DISCLAIMER: ACCURACY OF THESE PLANS IS NOT GUARANTEED. FOR INDICATIVE LOCATIONS ONLY. MAKE YOUR OWN ENQUIRIES.

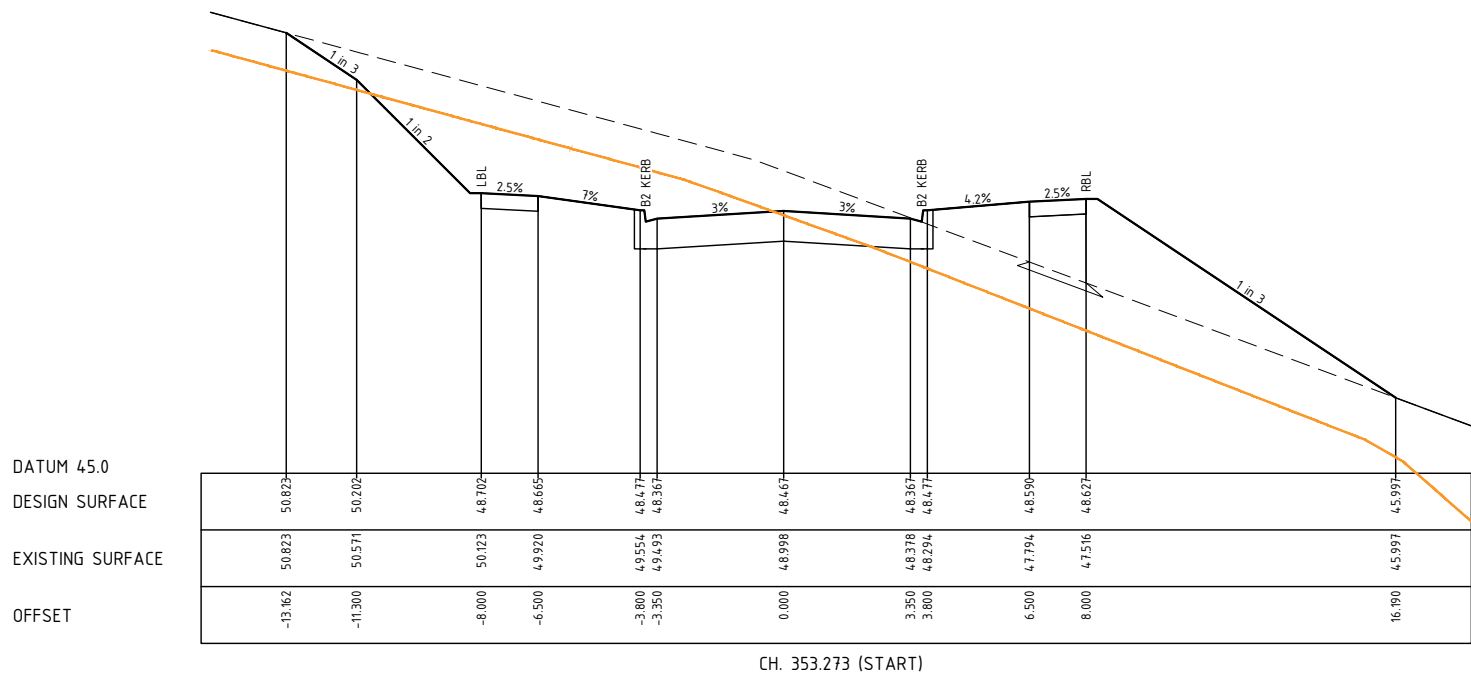
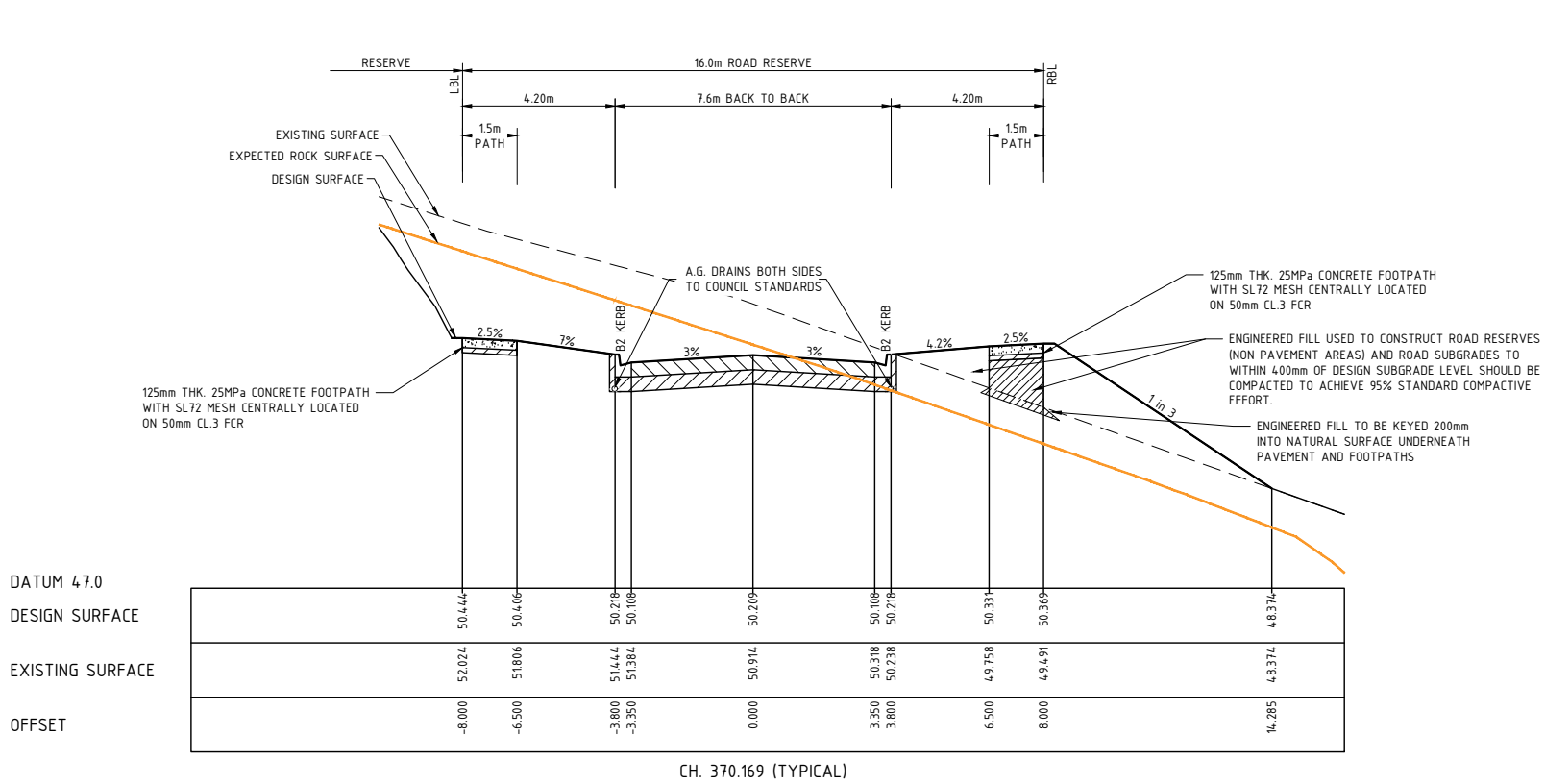

MAJESTIC DRIVE - CROSS SECTIONS

HORZ: 1:200
VERT: 1:100

FOR CONSTRUCTION

ISSUE	ISSUED FOR	DATE	No.	AMENDMENT	DATE	DRAWN	APPROVED	DESIGNED	DATE	CLIENT	PROJECT	STAGE	DRAWING TITLE	CardnoTGM REF. No.	SHEET	OF	REV.
00	FOR APPROVAL	27/04/18						D. RICHARDSON	APRIL 2018	GEELONG LAND GROUP PTY LTD	HightonRidge	STAGE 10C	CIVIL DRAWING		6	12	
01	FOR CONSTRUCTION	10/09/19						H. SMITH	SCALE: H 1:200 V 1:100	P.O BOX 315		HIGHTON	ROAD CROSS SECTIONS				
A	FOR CONSTRUCTION	10/02/2020						CARDNO TGM GEELONG	SHEET SIZE: A3	GEELONG, VIC, 3220		VIC, 3216	MAJESTIC DRIVE	007138-210C	6	12	A
								CHECKED: <i>[Signature]</i>	APPROVED: <i>[Signature]</i>								
								POS NO: PS 809797 S	VERSION: D4								
								PERMIT NO: 717/2007/F									
								WORKS SHALL NOT COMMENCE UNTIL PLANS ARE SIGNED AND APPROVED FOR CONSTRUCTION									
								ABN 11 125 568 461									
								Level 1, 27-31 Myers Street (PO Box 1137) Geelong, VIC Australia 3220									
								Phone +61 3 5202 4000 Fax +61 3 5202 4891									
								Email: victoria@cardno.com.au Web: www.cardno.com									
								JAS-ANZ Accredited: Quality ISO 9001 - CHMS AS/NZS 4801 - Environment ISO 14001									
								THIS ELECTRONIC DRAWING IS PRODUCED BY AUTOCAD (R) SYSTEMS AND REMAINS THE PROPERTY OF CardnoTGM Group Pty Ltd. IT MAY NOT BE REPRODUCED IN ANY FORMAT WITHOUT WRITTEN PERMISSION									

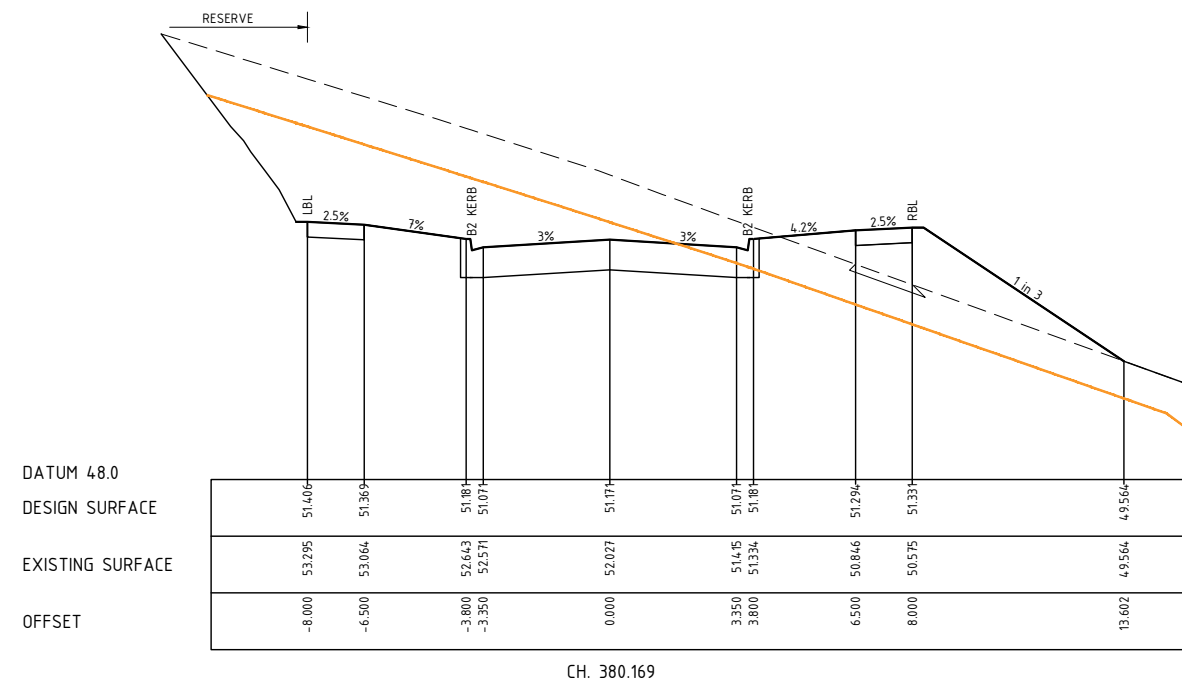

HORZ: 1:200
VERT: 1:100

FOR CONSTRUCTION

[illegible]

DISCLAIMER: ACCURACY OF THESE PLANS IS NOT GUARANTEED. FOR INDICATIVE LOCATIONS ONLY. MAKE YOUR OWN ENQUIRIES.

TP = TANGENT POINT
CREST = HIGH POINT
SAG = LOW POINT
P = INTERSECTION POINT

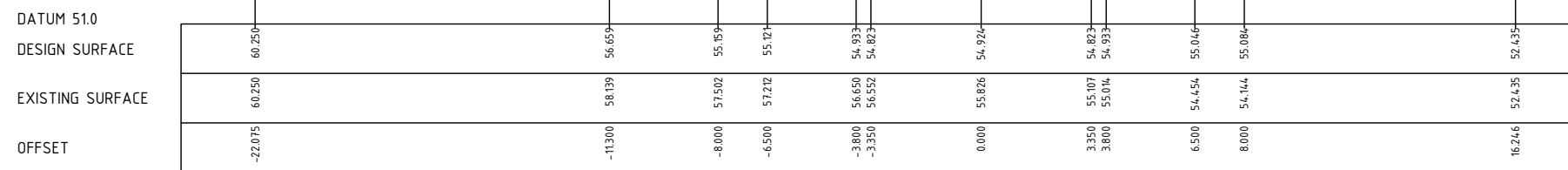

HORZ: 1:200
VERT: 1:100

ISSUE	ISSUED FOR	DATE	No.	AMENDMENT	DATE	DRAWN	APPROVED	DESIGNED: D. RICHARDSON	DATE: APRIL 2018	 <p>Cardno TGM</p> <p>ABN 11 125 568 461 Level 1, 27-31 Myers Street (P.O. Box 1137) Geelong, VIC Australia 3220 Phone +613 5202 4600 Fax +613 5202 4691 Email: victoria@cardno.com.au Web: www.cardno.com</p> <p>JAS-ANZ Accredited: Quality ISO 9001 - OHAS AS/NZS 4801 - Environment ISO 14001</p>	CLIENT:	PROJECT:	 <p>STAGE 10C HIGHTON VIC, 3216</p> <p>CITY OF GREATER GEELONG</p>	<p>CIVIL DRAWING</p> <p>DRAWING TITLE: ROAD CROSS SECTIONS MAJESTIC DRIVE</p> <p>CardnoTGM REF. No: 007138-210C</p> <p>SHEET: 8 OF 12 REV: A</p>
00	FOR APPROVAL	27/04/18						DRAWN: H. SMITH	SCALE: H 1:200 V 1:100		GEELONG LAND GROUP PTY LTD	<p>THIS ELECTRONIC DRAWING IS PRODUCED BY AUTOCAD R21 SYSTEMS AND REMAINS THE PROPERTY OF CardnoTGM Group Pty Ltd. IT MAY NOT BE REPRODUCED IN ANY FORMAT WITHOUT WRITTEN PERMISSION.</p>		
01	FOR CONSTRUCTION	10/09/19						SURVEY: CARDNO TGM GEELONG	SHEET SIZE: A3		P.O BOX 315			
A	FOR CONSTRUCTION	10/02/2020						CHECKED: 	APPROVED: 		GEELONG, VIC, 3220			
								POS NO: PS 809797 S VERSION: D4 PERMIT NO: 717/2007/F						
<p>WORKS SHALL NOT COMMENCE UNTIL PLANS ARE SIGNED AND APPROVED FOR CONSTRUCTION.</p>														

J:\007138 (HIGHTON RIDGE)\210C-CE\DWG\007138-210C (CIVIL) REVA.DWG

DISCLAIMER: ACCURACY OF THESE PLANS IS NOT GUARANTEED. FOR INDICATIVE LOCATIONS ONLY. MAKE YOUR OWN ENQUIRIES.

ALWAYS CHECK THE SERVICES ON THE LOT! DO NOT RELY SOLELY ON THIS PLAN!

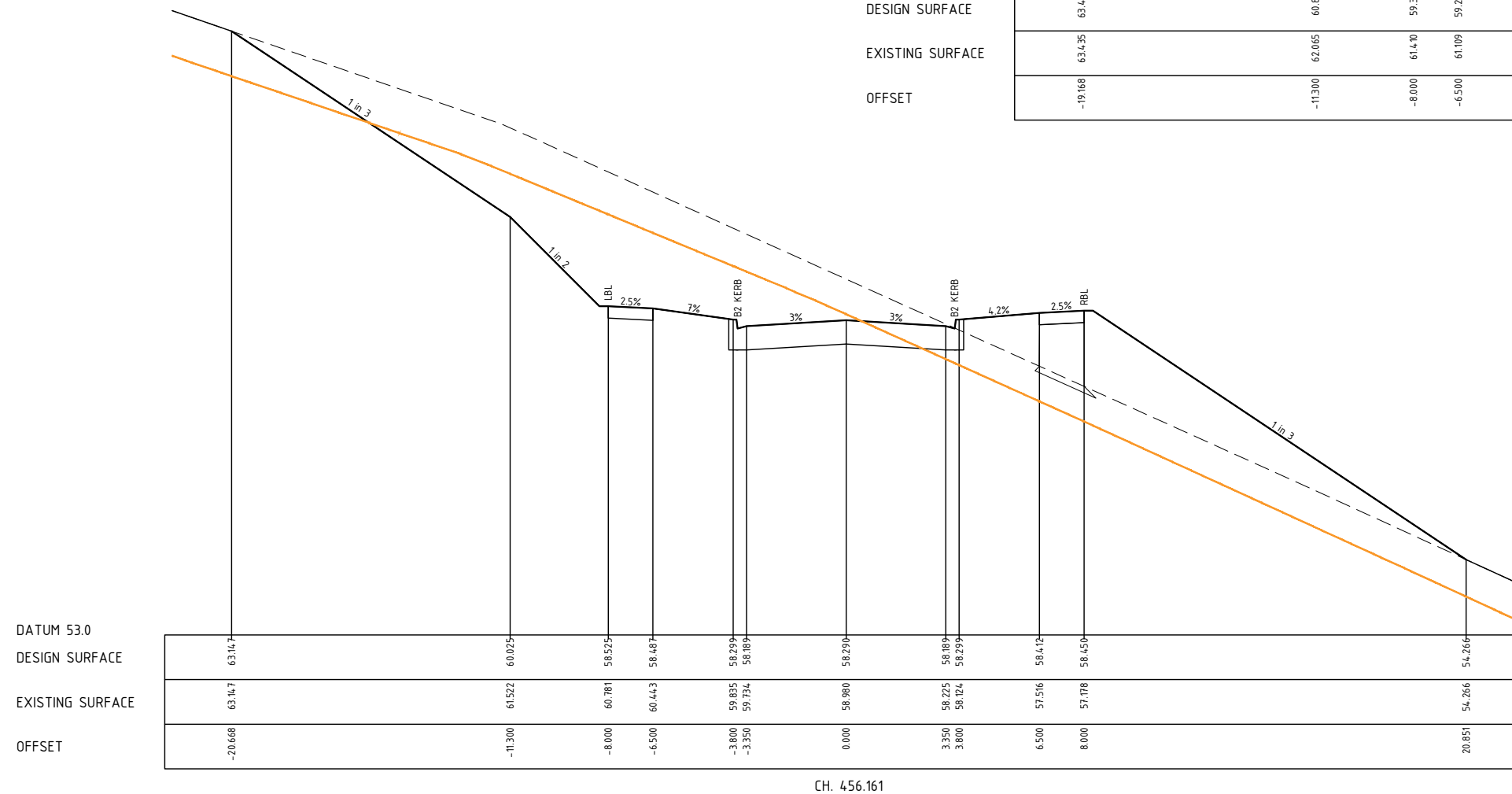
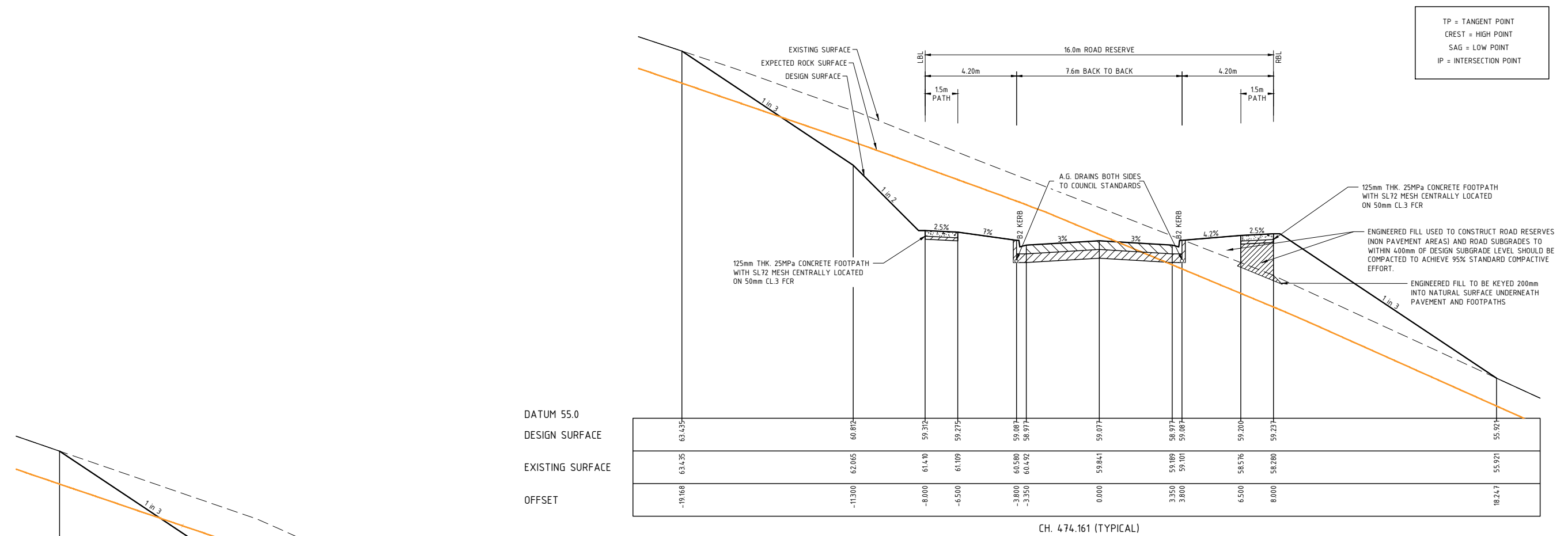

MAJESTIC DRIVE - CROSS SECTIONS

HORZ: 1:200
VERT: 1:100

FOR CONSTRUCTION

ISSUE	ISSUED FOR	DATE	No.	AMENDMENT	DATE	DRAWN	APPROVED	DESIGNED:	D. RICHARDSON	DATE:	APRIL 2018
00	FOR APPROVAL	27/04/18						DRAWN:	H. SMITH	SCALE:	H 1:200 V 1:100
01	FOR CONSTRUCTION	10/09/19						SURVEY:	CARDNO TGM GEELONG	SHEET SIZE:	A3
A	FOR CONSTRUCTION	10/02/2020						CHECKED:		APPROVED:	
								POS NO:	PS 809797 S	VERSION:	D4
								PERMIT NO:	717/2007/F		
									WORKS SHALL NOT COMMENCE UNTIL PLANS ARE SIGNED AND APPROVED FOR CONSTRUCTION		

Level 1, 27-31 Myers Street (P.O Box 1137) Geelong, VIC Australia 3220
Phone +61 3 5202 4600 Fax +61 3 5202 4691
Email: victoria@cardno.com.au Web: www.cardno.com

JAS-ANZ Accredited: Quality ISO 9001 - OH&A AS/NZS 4801 - Environment ISO 14001

CLIENT:

GEELONG LAND GROUP PTY LTD
P.O BOX 315
GEELONG, VIC, 3220

PROJECT:

STAGE 10C
HIGHTON
VIC, 3216

CITY OF GREATER GEELONG

DRAWING TITLE:

ROAD CROSS SECTIONS
MAJESTIC DRIVE

CardnoTGM REF. No:

007138-210C

SHEET:

9 OF 12

REV:

A

J:\007138 (HIGHTON RIDGE)\210C-CE\DWG\007138-210C (CIVIL) REVA.DWG

DISCLAIMER: ACCURACY OF THESE PLANS IS NOT GUARANTEED. FOR INDICATIVE LOCATIONS ONLY. MAKE YOUR OWN ENQUIRIES.

ALWAYS CHECK THE SERVICES ON THE LOT! DO NOT RELY SOLELY ON THIS PLAN!

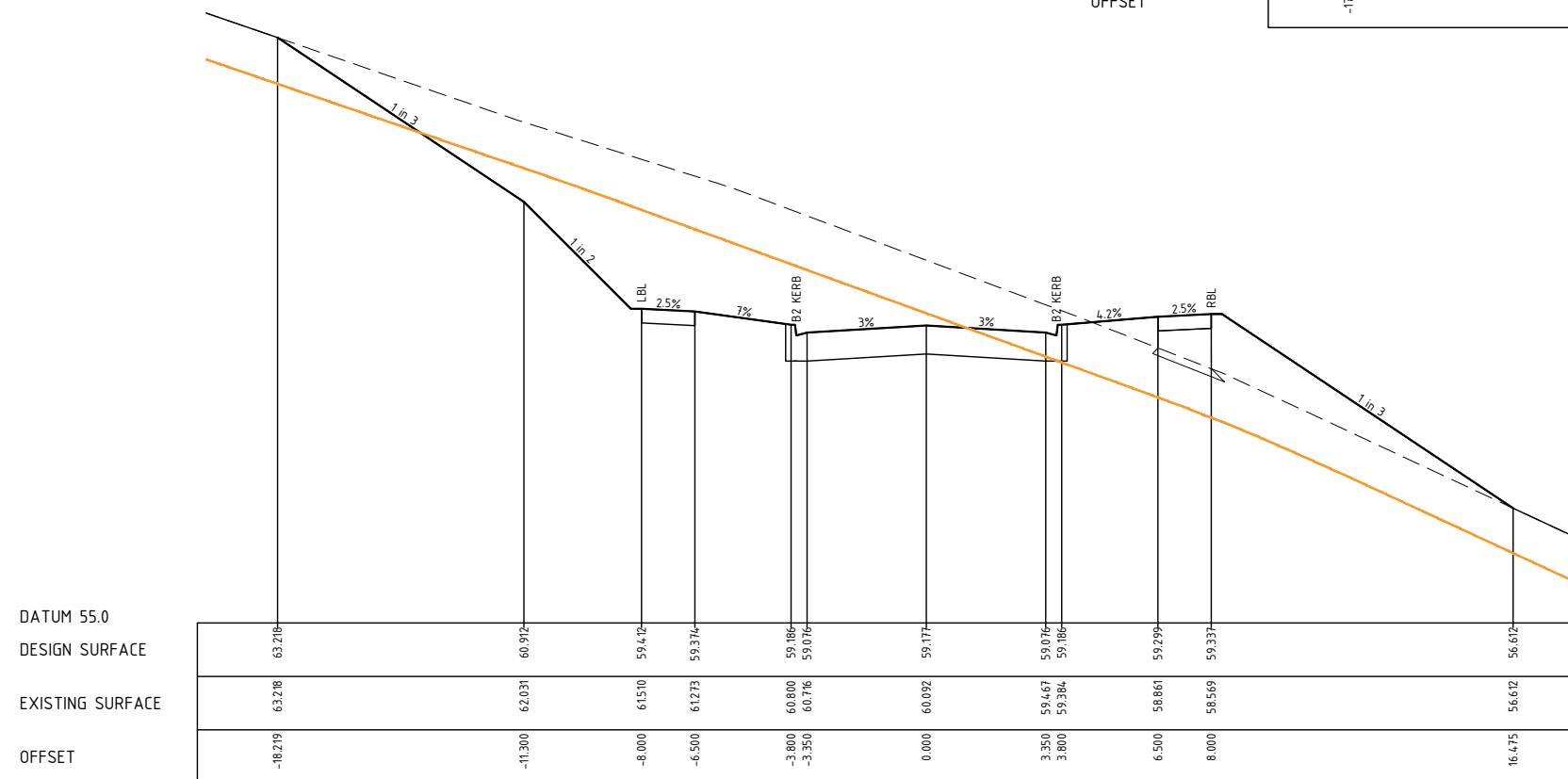
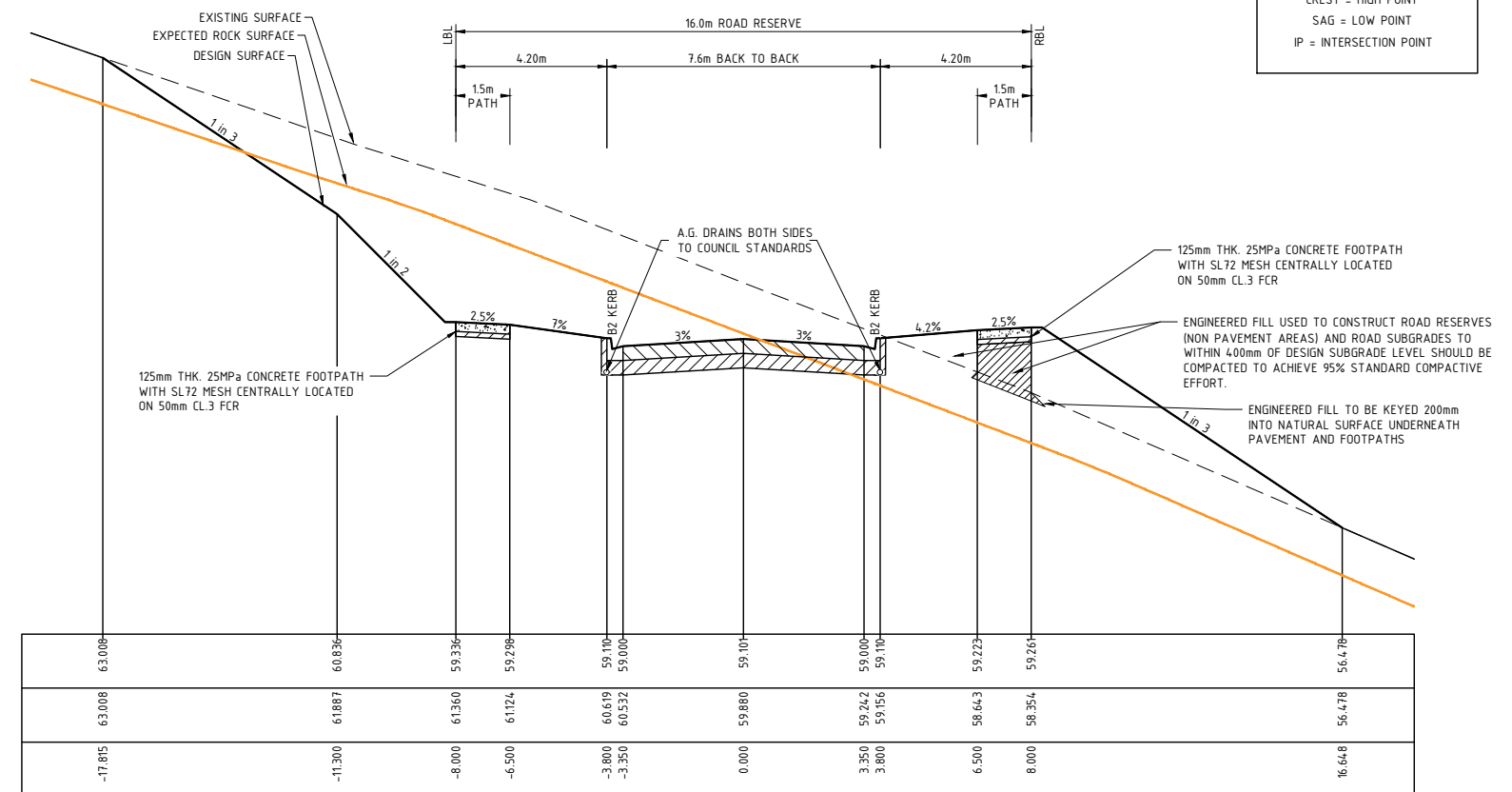

CH. 483.236 (CREST)

MAJESTIC DRIVE - CROSS SECTIONS

HORZ: 1:200
VERT: 1:100

FOR CONSTRUCTION

ISSUE		ISSUED FOR		DATE	No.	AMENDMENT		DATE	DRAWN	APPROVED	DESIGNED	D. RICHARDSON		DATE	APRIL 2018		<div><p>Cardno TGM</p><p>ABN 11 125 568 461 Level 1, 27-31 Myers Street (PO Box 1137) Geelong, VIC Australia 3220 Phone +61 3 5202 4600 Fax +61 3 5202 4661 Email: victoria@cardno.com.au Web: www.cardno.com</p><p>JAS-ANZ Accredited: Quality ISO 9001 - CHAS AS/NZS 4501 - Environment ISO 14001</p></div>	CLIENT:		GEELONG LAND GROUP PTY LTD P.O BOX 315 GEELONG, VIC, 3220		PROJECT:	<div><p>STAGE 10C HIGHTON VIC, 3216</p><p>CITY OF GREATER GEELONG</p></div>		CIVIL DRAWING		
00		FOR APPROVAL		27/04/18							DRAWN:	H. SMITH		SCALE:	H 1:200 V 1:100			<p>DRAWING TITLE:</p> <p>ROAD CROSS SECTIONS MAJESTIC DRIVE</p> <p>CardnoTGM REF. No: 007138-210C</p>	SHEET		10	OF	12	REV.	A		
01		FOR CONSTRUCTION		10/09/19							SURVEY:	CARDNO TGM GEELONG		SHEET SIZE:	A3												
A		FOR CONSTRUCTION		10/02/2020							CHECKED:			APPROVED:													
											POS NO:	PS 809797 S		VERSION:	04				PERMIT NO:	711/2007/F							
WORKS SHALL NOT COMMENCE UNTIL PLANS ARE SIGNED AND APPROVED FOR CONSTRUCTION.													THIS ELECTRONIC DRAWING IS PRODUCED BY AUTOCAD (R) SYSTEMS AND REMAINS THE PROPERTY OF CardnoTGM GROUP Pty. Ltd. IT MAY NOT BE REPRODUCED IN ANY FORMAT WITHOUT WRITTEN PERMISSION.														

J:\007138 (HIGHTON RIDGE)\210C-CE\DWG\007138-210C (CIVIL) REVA.DWG

DISCLAIMER: ACCURACY OF THESE PLANS IS NOT GUARANTEED. FOR INDICATIVE LOCATIONS ONLY. MAKE YOUR OWN ENQUIRIES.

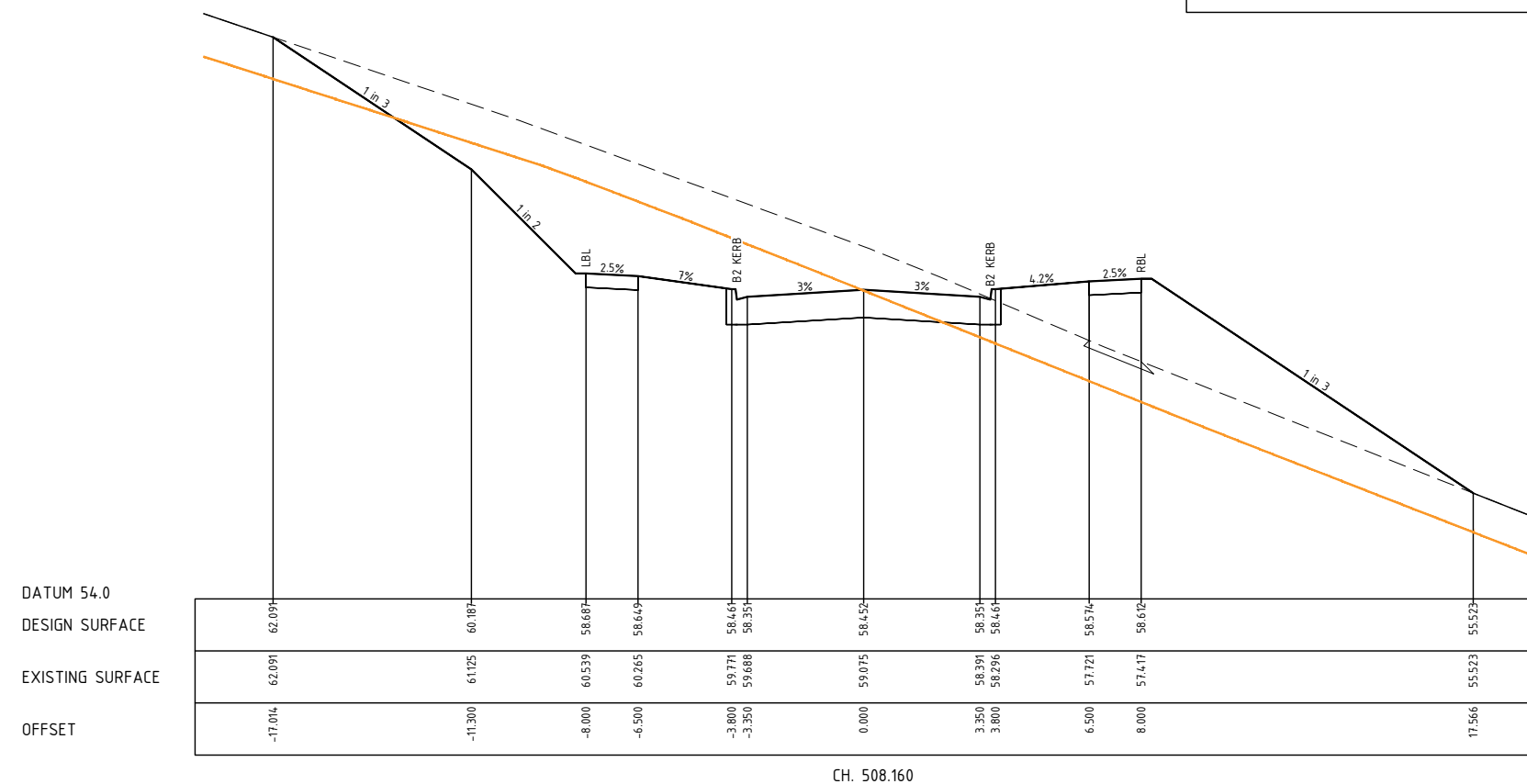
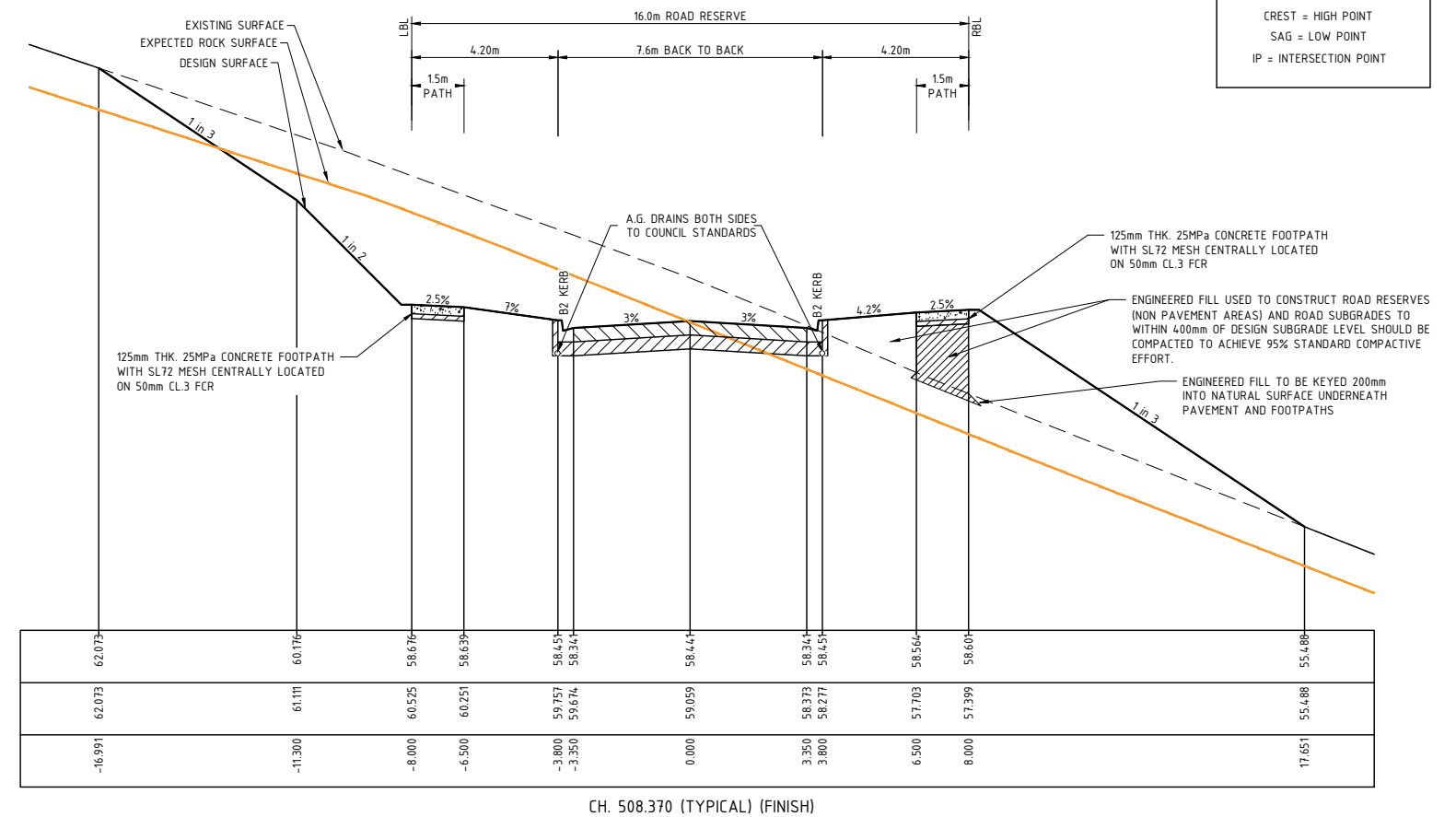

MAJESTIC DRIVE - CROSS SECTIONS

HORZ: 1:200
VERT: 1:100

FOR CONSTRUCTION

ISSUE	ISSUED FOR	DATE	No.	AMENDMENT	DATE	DRAWN	APPROVED	DESIGNED:	D. RICHARDSON	DATE:	APRIL 2018
00	FOR APPROVAL	27/04/18						DRAWN:	H. SMITH	SCALE:	H 1:200 V 1:100
01	FOR CONSTRUCTION	10/09/19						SURVEY:	CARDNO TGM GEELONG	SHEET SIZE:	A3
A	FOR CONSTRUCTION	10/02/2020						CHECKED:		APPROVED:	
								POS NO:	PS 809797 S	VERSION:	D4
								PERMIT NO:	717/2007/F		
									WORKS SHALL NOT COMMENCE UNTIL PLANS ARE SIGNED AND APPROVED FOR CONSTRUCTION		

Level 1, 27-31 Myers Street (P.O Box 1137) Geelong, VIC Australia 3220
Phone +61 3 5202 4600 Fax +61 3 5202 4691
Email: victoria@cardno.com.au Web: www.cardno.com

JAS-ANZ Accredited: Quality ISO 9001 - OH&A AS/NZS 4801 - Environment ISO 14001

CLIENT:

GEELONG LAND GROUP PTY LTD
P.O BOX 315
GEELONG, VIC, 3220

PROJECT:

STAGE 10C
HIGHTON
VIC, 3216

CITY OF GREATER GEELONG

DRAWING TITLE:
**ROAD CROSS SECTIONS
MAJESTIC DRIVE**

CardnoTGM REF. No: **007138-210C**

SHEET: **11** OF **12** REV: **A**

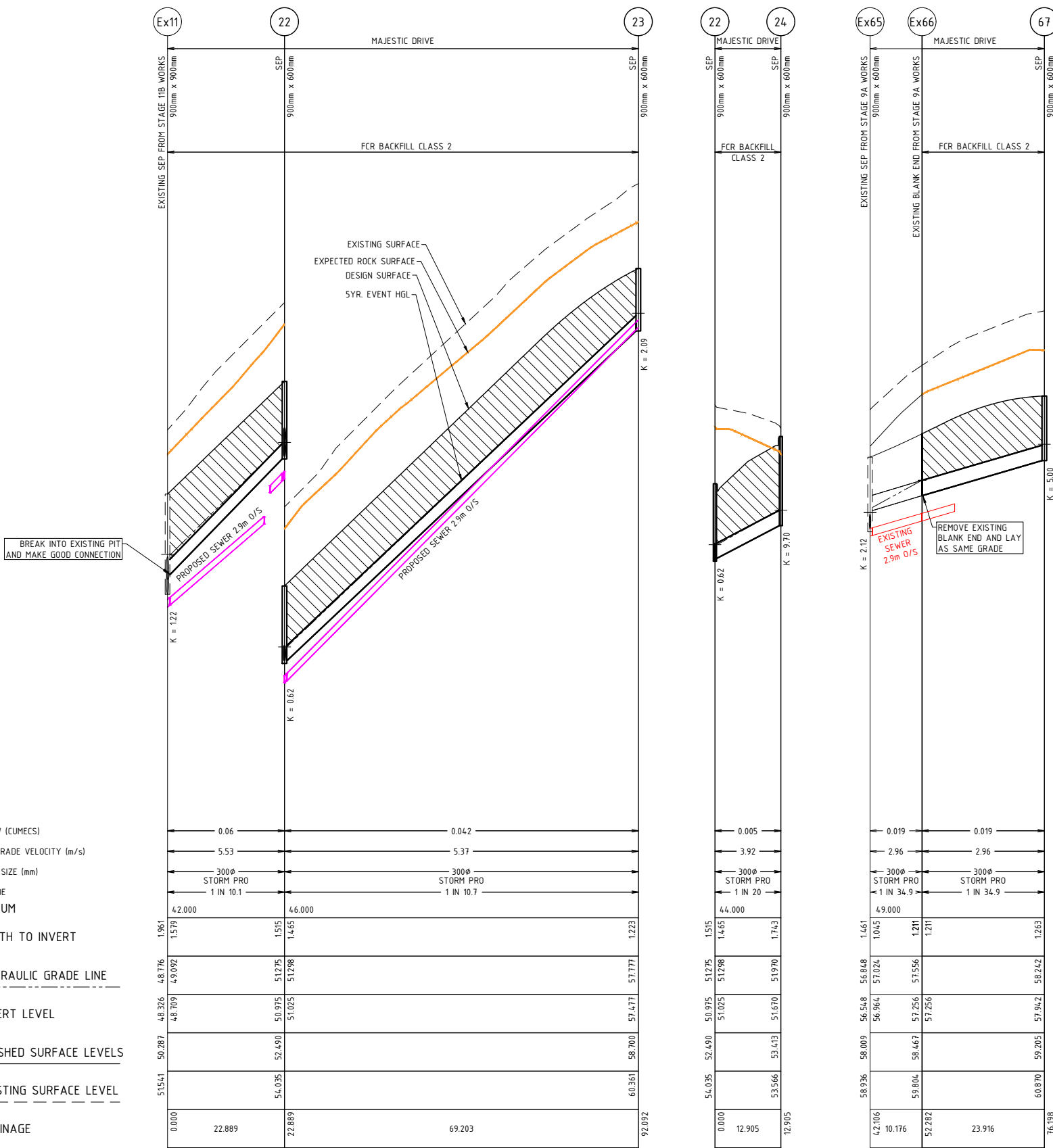

PIT SCHEDULE

PIT NAME	TYPE	EASTING	NORTHING	INTERNAL LEN	WD	FROM	DIA	INV LEV	OUTLET DIA	INV LEV	PIT SETOUT RL	DEPTH	COVER	REMARKS
Ex.11	EXIST SEP	263126.912	5773547.016	900	900	Ex.12	450	48.614	450	48.326	50.287	1.961	CLASS D	Break into existing pit - adjust cover to match new surface level
Ex.12	EXIST JP	263139.559	5773542.296	1500	900	Ex.A	450	52.825	450	49.846	53.790	3.944	CLASS D	Existing pit - adjust cover to match new surface levels
Ex.A	EXIST JP	263164.337	5773541.724	900	900	---	---	---	450	54.283	58.110	3.827	---	Existing pit - adjust cover to match new surface levels
22	SEP	263126.384	5773524.132	900	600	23	300	51.025	300	50.975	52.490	1.515	CLASS D	Refer IDM SD 430
23	SEP	263124.793	5773454.948	900	600	---	---	---	300	51.477	58.700	1.223	CLASS D	Refer IDM SD 430
24	SEP	263117.964	5773514.646	900	600	---	---	---	300	51.670	53.413	1.743	CLASS D	Refer IDM SD 430
Ex.65	EXIST SEP	263123.508	5773399.071	900	600	66	300	56.964	300	56.548	58.009	1.461	CLASS D	Existing pit
Ex.66	EXIST B.END	263123.742	5773409.244	---	---	69	300	56.598	---	---	---	---	---	Existing blank end
67	SEP	263124.292	5773433.154	900	600	---	---	---	300	57.942	59.205	1.263	CLASS D	Refer IDM SD 430
Ex.B	EXIST JP	263076.221	5773565.722	900	900	Ex.70	300	38.743	375	38.693	40.393	1.700	CLASS B	Existing pit - adjust cover to match new surface levels
Ex.70	EXIST JP	263073.273	5773505.809	900	900	Ex.71	300	44.365	300	43.357	45.227	1.870	---	Existing pit - adjust cover to match new surface levels
Ex.71	EXIST JP	263069.835	5773435.917	900	600	Ex.72	225	47.549	300	47.499	48.822	1.322	---	Existing pit - adjust cover to match new surface levels

- NOTE:
- ALL SETOUT POINTS QUOTED TO CENTRE OF 900x600 PIT e.g.:
 - SEP PITS NOTED WITH 'x' TO BE HAUNCHED TO A 900x600 (INTERNAL) OPENING WITH APPROPRIATE COVER.
 - DSEP PITS NOTED WITH 'xx' TO BE HAUNCHED TO A 1900x600 (INTERNAL) OPENING WITH APPROPRIATE COVER.
 - ALL HAUNCHING TO BE IN ACCORDANCE WITH IDM SD 410
 - ALL DRAINAGE PIT LIDS ARE TO BE 'TERRA-FIRMA' OR APPROVED EQUIVALENT.

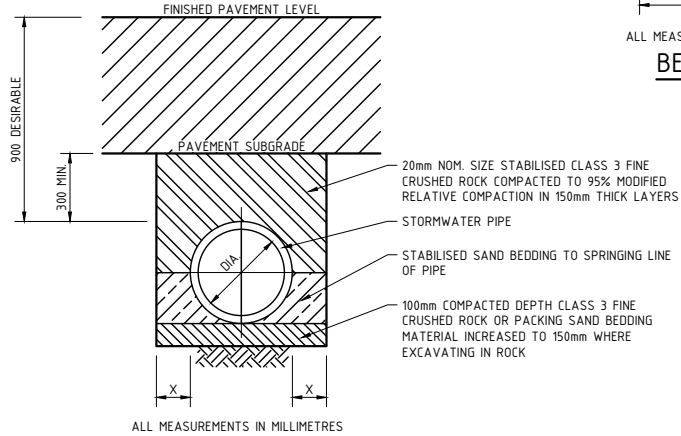
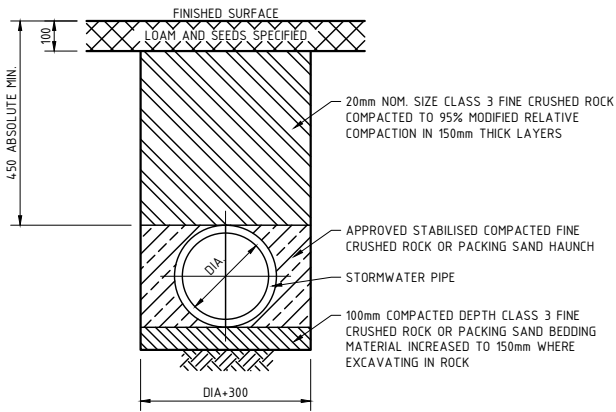

UNDER ROAD PAVEMENT BACKFILL DETAIL

- NOTES:
- TRENCHING DETAILS INDICATIVE ONLY AND SHOULD BE INSTALLED TO MANUFACTURERS SPECIFICATIONS.
 - WHERE PIPE IS BEHIND KERB AND CHANNEL, INSTALL ONE METRE (1m) MINIMUM OF APPROVED 90+ CLASS 400 SLOTTED/ PERFORATED SUBSOIL DRAIN WITH GEOTEXTILE SOCK SURROUND INTO PIT IN LIEU OF SUB-SOIL DRAINAGE BEHIND KERB.
 - BACKFILL DESIGN TO BE IN ACCORDANCE WITH CEMENT & CONCRETE ASSOCIATION OF AUSTRALIA 'PIPE CLASS' REQUIREMENTS. BACKFILL UNDER ROAD PAVEMENT TO BE STABILISED WHERE CCAA INFORMATION IS NOT AVAILABLE.
 - APPROVAL MAY BE GIVEN FOR USE OF BACKFILL MATERIAL OTHER THAN CRUSHED ROCK WHERE IT CAN BE DEMONSTRATED THAT A MINIMUM OF 95% MODIFIED RELATIVE COMPACTION CAN BE ACHIEVED.
 - CEMENT, CONCRETE OR CEMENT STABILISED CRUSHED ROCK TO BE USED WHERE SETTLEMENT OF TRENCH WILL EFFECT INFRASTRUCTURE.

FOR CONSTRUCTION

ISSUE	ISSUED FOR	DATE	No.	AMENDMENT	DATE	DRAWN	APPROVED	DESIGNED	D. RICHARDSON	DATE	APRIL 2018	CLIENT	GEELONG LAND GROUP PTY LTD	PROJECT	STAGE 10C	CIVIL DRAWING
00	FOR APPROVAL	27/04/18						DRAWN	H. SMITH	SCALE	REFER SHEET		P.O BOX 315		HIGHTON	DRAWING TITLE:
01	FOR CONSTRUCTION	10/09/19						SURVEY	CARDNO TGM GEELONG	SHEET SIZE	A3		GEELONG, VIC, 3220		VIC, 3216	DRAINAGE LONGITUDINAL SECTIONS
A	FOR CONSTRUCTION	10/02/2020						CHECKED	[Signature]	APPROVED	[Signature]					AND PIT SCHEDULE
								POS NO	PS 809797 S	VERSION	D4					CardnoTGM REF. No.
								PERMIT NO	717/2007/F							007138-210C
																SHEET 12 OF 12
																REV A